



impact solar

Your Wholesale Solar Specialists

The SR4000 series of PV/LED products represents an exciting addition to Impact Solar’s range of energy saving products for the Australian Industry. Never before has there been such a ground-swell of support in Australia and around the world for reduction of greenhouse emissions and unity of support for providing our future generations with a cleaner, healthier and more sustainable environment.

The SR4200 Solar Motion light integrates a compact PV panel with Grade A+ long life batteries and an intelligent sensing system, the SR4200 auto sensing solar motion light has a 16LED display that will detect motion and switch from 30% power (dim mode) to 100% power.

Features & Benefits

- Easy to install on walls, trees, metal and glass
- Intelligent sensing system provides overcharge, overvoltage, short circuit and more security protection
- Auto-sensing – detects light brightness and human motion automatically
- During day-light, the unit will stay inactive even when movement is detected
- No wiring, solar power, convenient and safe
- Housing material is high quality ABS + PC, dustproof and rated IP65 waterproof, perfect for outdoor use



Specifications

- Solar Panel – 5.5V 0.75W
- Power – 1 Watt
- Size – L105 x W53 x H138mm
- Sensor angle – 90 to 120 degrees
- Sensitivity distance – 3 metres
- Working temperature - -5 to 60C

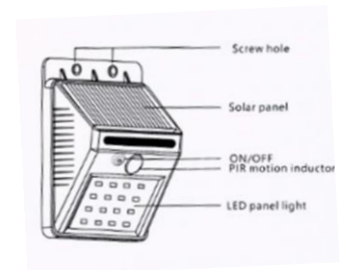
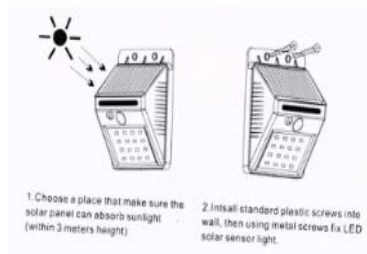

sales & orders 07 5370 6249

email: sales@impactsolar.com.au

website: www.impactsolar.com.au

4-10 Jeffreys Rd. Glass House Mountains Qld 4518

