



WIFI MONITORING SETUP GUIDE

V1.1

Trina Energy Storage Solutions (Jiangsu) Co.,Ltd.

Add: No. 2 Tianhe Road, Trina PV Industrial Park, New District, Changzhou, Jiangsu, China 213031

[http: //www.trinaenergystorage.com](http://www.trinaenergystorage.com);

Tel: (+86)0519-85176686

Fax: (+86)0519-81588398

Establishing a WLAN (Wi-Fi) connection to the user interface and setting up the monitoring on smart device

1. Open the WLAN interface of the inverter by connecting to the inverter's SSID (Wifi name)

1.1 How to identify Inverter SSID in WLAN: [AP_serial number(SN)] (e.g. fig. 1, 0805574402), See SN on the label on the side of the inverter

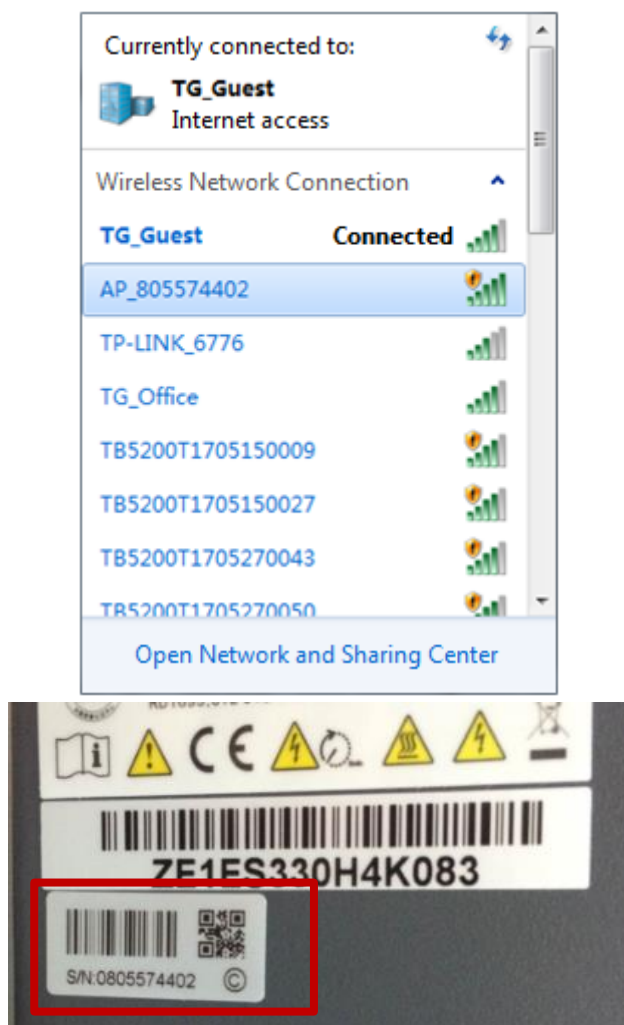

Figure 1 WLAN Connection and Serial Number (SN)

1.2 Open up an internet browser using a computer PC or from any smart device. Enter the inverter IP address in the address bar (URL) to open up its settings and configurations: 10.10.100.254, (default username / password: admin / admin)



Figure 2 Login Interface for Wizard

2. Using the wizard to set up the WLAN monitoring

2.1 Click Start button under Wizard

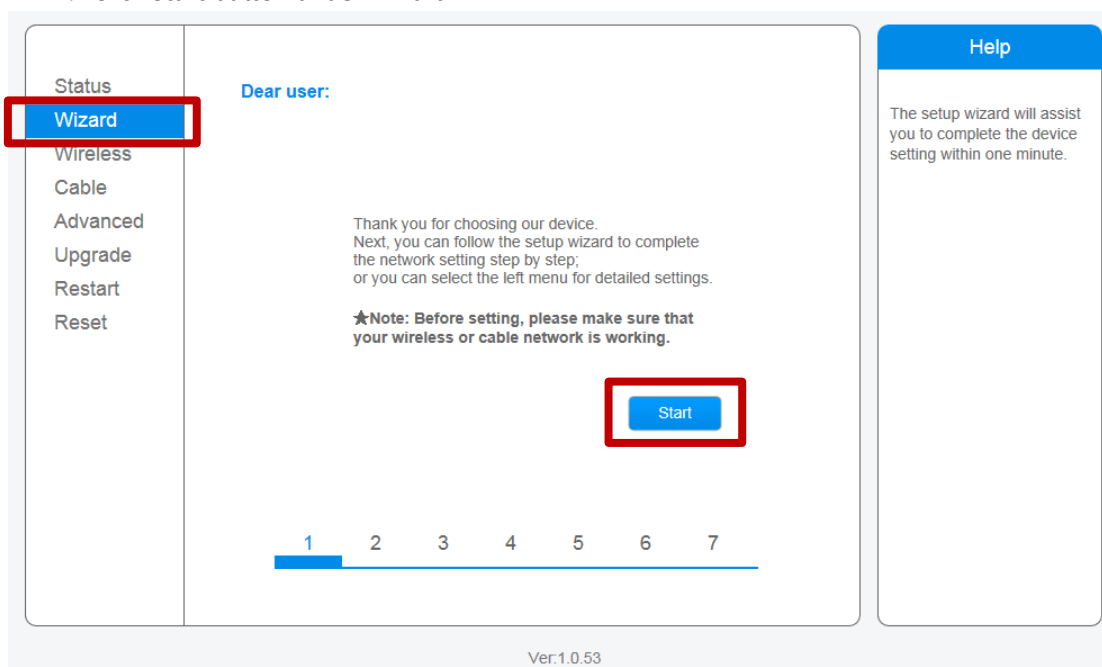

Figure 3 Wizard setting Step1

2.2 Select Wireless connection, click NEXT

Status
Wizard
 Wireless
 Cable
 Advanced
 Upgrade
 Restart
 Reset

Connection Settings:

☒ Wireless connection
☐ Cable connection

Wireless **Enabled** ▼

Back **Next**

1 2 3 4 5 6 7

Ver:1.0.53

Help

The STA mode of wireless connection will be turned off by system automatically when you choose cable network connection.

Whether to keep the AP mode of wireless connection or not can be set by turning on or off the wireless function.

Figure 4 Wizard setting Step2

2.3 Then, select your current wireless network:

Status
Wizard
 Wireless
 Cable
 Advanced
 Upgrade
 Restart
 Reset

Please select your current wireless network:

Site Survey

SSID	BSSID	RSSI	Channel
TP-LINK_6776	bc:46:99:5e:67:76	60%	1
<input checked="" type="radio"/> TG_Guest	54:4a:00:79:a2:f0	55%	4
<input type="radio"/> TG_Office	54:4a:00:79:a2:f1	55%	4
<input type="radio"/> TB5200T1705270047	c8:93:46:34:61:dd	34%	9
<input type="radio"/> TB5200T1705270036	c8:93:46:34:62:35	60%	9
<input type="radio"/> TB5200T1705270015	c8:93:46:34:5e:6e	65%	9
<input type="radio"/> TB5200T1705270063	c8:93:46:34:5d:e5	39%	9
<input type="radio"/> TB5200T1705270008	c8:93:46:34:60:d4	50%	9
<input type="radio"/> TB5200T1705150007	c8:93:46:34:62:ea	24%	9
<input type="radio"/> TB5200T1705270050	c8:93:46:34:63:67	34%	9

★Note: When RSSI of the selected WiFi network is lower than 15%, the connection may be unstable, please select other available network or shorten the distance between the device and router.

Refresh

Add wireless network manually:

Network name (SSID)
 (Note: case sensitive) TG_Guest

Encryption method WPA2PSK ▼

Encryption algorithm AES ▼

Back **Next**

Help

This step will help to connect the device to your desired WLAN. If you do not find your wireless router on the left list, please refresh several times or add it manually.

Please check your wireless router for the right encryption method and encryption algorithm.

If your wireless router does not broadcast SSID, please add a wireless network manually.

Figure 5 local Wi-Fi Selection

2.4 enter your WLAN/Wi-Fi password and re-enter it again, Click NEXT

Status Wizard Wireless Cable Advanced Upgrade Restart Reset	<p>Please enter the wireless network password:</p> <p>Password (8-64 bytes) (Note: case sensitive) Re-enter password</p> <div> <input type="password"/> <input type="password"/> </div> <p><input type="checkbox"/> Show Password</p> <p>Back Next</p> <p>1 2 3 4 5 6 7</p>	<p>Help</p> <p>Please make sure you have entered the correct password.</p>
	<p>Ver:1.0.53</p>	

Figure 6 Wizard setting Step 4

2.5 Select 'Enable' for Obtain an IP address automatically, and click 'next'

Status Wizard Wireless Cable Advanced Upgrade Restart Reset	<p>Please fill in the following information:</p> <p>Obtain an IP address automatically <input checked="" type="button" value="Enable"/></p> <p>IP address <input type="text" value="0.0.0.0"/></p> <p>Subnet mask <input type="text" value="0.0.0.0"/></p> <p>Gateway address <input type="text" value="0.0.0.0"/></p> <p>DNS server address <input type="text"/></p> <p>Back Next</p> <p>1 2 3 4 5 6 7</p>	<p>Help</p> <p>Most systems support the function of DHCP to obtain IP address automatically. Please select disable and add it manually if your router does not support such function.</p>
	<p>Ver:1.0.53</p>	

Figure 7 Wizard setting Step 5

2.6 Do not select any option under steps 6, click NEXT

Status Wizard Wireless Cable Advanced Upgrade Restart Reset	<h3>Enhance Security</h3> <p>You can enhance your system security by choosing the following methods</p> <p>Hide AP <input type="checkbox"/></p> <p>Change the encryption mode for AP <input type="checkbox"/></p> <p>Change the user name and password for Web server <input type="checkbox"/></p> <p>Back Next</p> <p>1 2 3 4 5 6 7</p>	<h3>Help</h3> <p>Hide AP The SSID of the AP network will be invisible if you hide the AP. Please enter the SSID manually when you need to connect to AP next time.</p> <p>Change the encryption mode for AP If you set password for the AP network, you will need to enter the password to connect to AP.</p> <p>Change the user name and password for Web server If you change the username and password for the web server, you will need to enter the new username and password</p>
---	---	---

Figure 8 Wizard setting Step 6

2.7 Click NEXT and wait for it to show 'Configuration completed!' then press OK to continue.

Status Wizard Wireless Cable Advanced Upgrade Restart Reset	<h3>Configuration completed!</h3> <p>Click OK, the settings will take effect and the system will restart immediately.</p> <p>If you leave this interface without clicking OK, the settings will be ineffective.</p> <p>Back OK</p> <p>1 2 3 4 5 6 7</p>	<h3>Help</h3> <p>After clicking OK, the system will restart immediately.</p>
---	---	--

Figure 9 Wizard setting Step 7

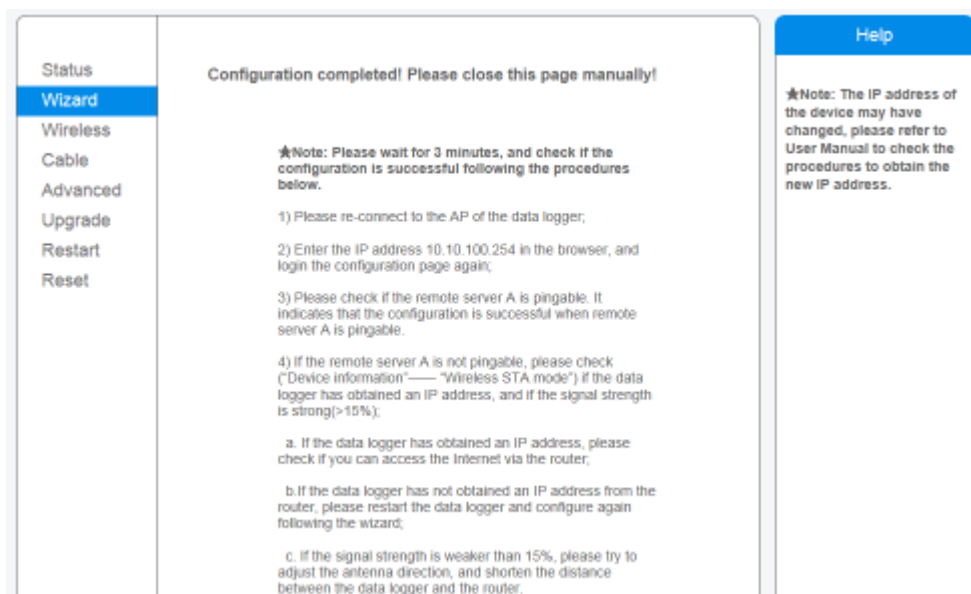
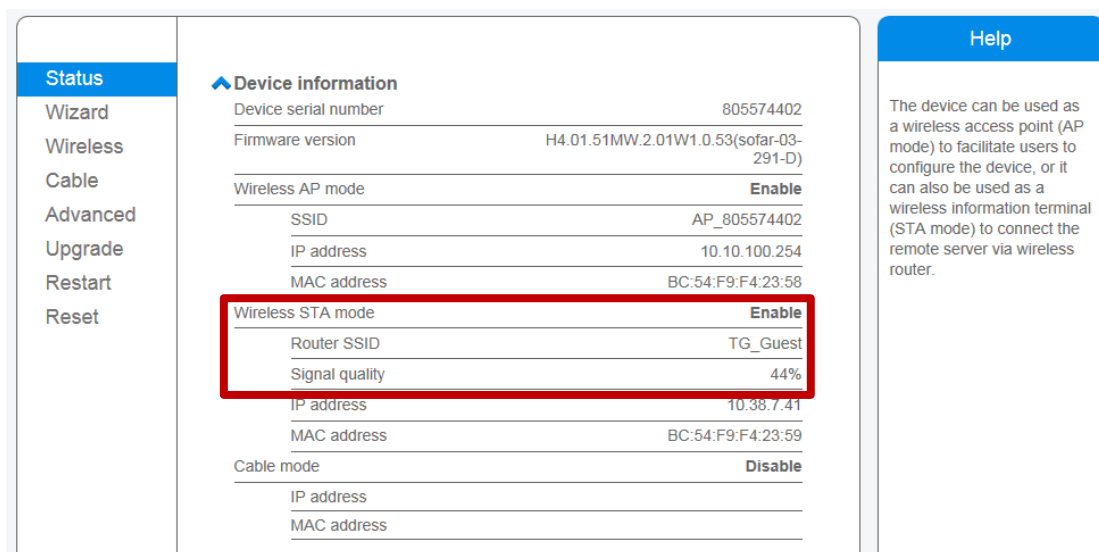

Figure 10 Finished Wizard setting

3. Select 'Status' and under Device Information confirm that the inverter Wi-Fi is connected to selected router SSID (WI-FI name). Also make sure 'Remote server A' is configured to 'Pingable'.



⬆ Connected Inverter	
Type	Trina
Number	1
Inverter serial number	TE1ES330H4K083 <input type="button" value="v"/>
Firmware version (main)	V031
Firmware version (slave)	---
Inverter model	TE1ES330
Rated power	---
Current power	0 W
Yield today	0 kWh
Total yield	0 kWh
Alerts	---
Last updated	0 min ago
⬆ Remote server information	
Remote server A	Pingable

Figure 11 Status Review

APP Installation and Monitoring Set Up

1. Download the monitoring app. Monitoring app can be found for both IOS and Android smart devices.

For IOS system: Search “**solarman**” in APP Store and install, or via this link

<https://itunes.apple.com/au/app/solarman-the-best-use-of-pv-owners-app/id1269498647?mt=8>

Or simply scan the QR code below:



Figure 12 Solarman app QR code for IOS device

For Android system: Search “**Solarman**” in Google Play and install, or via this link

<https://play.google.com/store/apps/details?id=com.igen.rrgf>

Or simply scan the QR code below:



Figure 13 Solarman app QR code for Android device

solarman–The best use of PV owners APP

By IGEN Tech Co., Ltd.

This app is only available on the App Store for iOS devices.

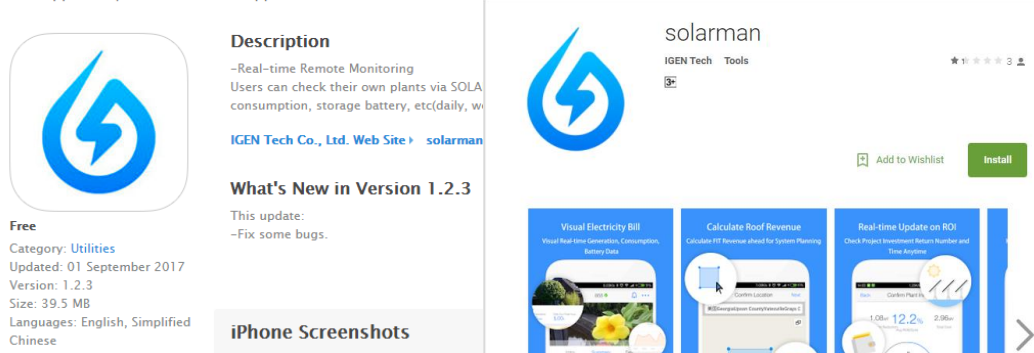
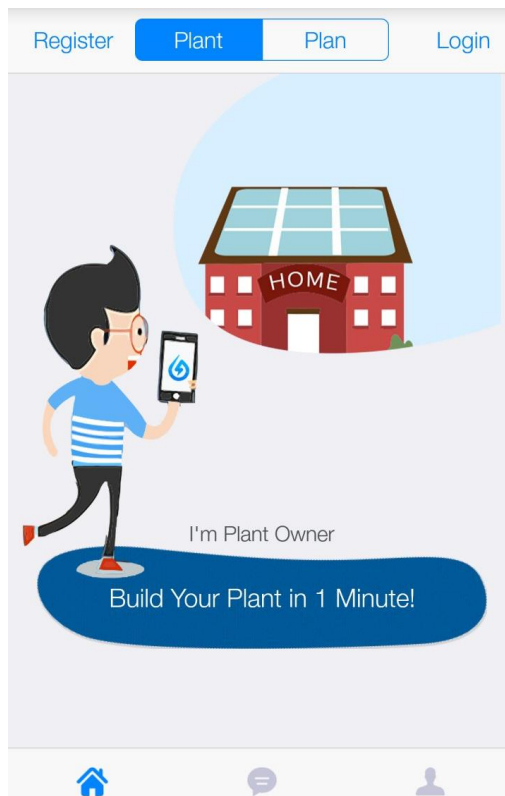

Figure 14 Download Page from IOS app store (left) and Google play (right)

2. Register/Login

Note!: Only one account is allowed to be set up per inverter (once the inverter WiFi has binded with an account, the user must delete the plant profile/WiFi logger to unbind the connection). It is suggested the installer sets up the account on behalf of the end user.

Open the APP and if you have an account, choose «Login», otherwise chose «Register».



a: Click “Login”

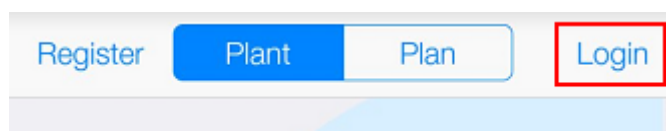

b: Input account and password

If you do not have an account, please choose “Register”

a: Choose “Register”

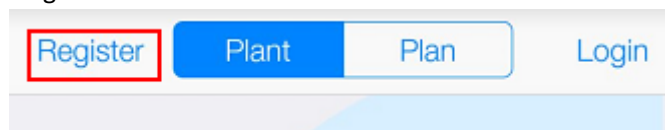



Notice

You could only use telephone number as account name in mainland China, for other areas please use email to register

b: Input username

c: Input email or phone number as account name

d: Set password

e: Choose “Register” to finish registration

f: After registration, choose “Login” to start using the APP

Cancel
Register

Username(English and Number)

Email or Chinese Number

Password(6 Digits at Least)

Register

• Plant setting



a. Choose on the left bottom to visit “Homepage”

b. Choose «Build your plant in 1 minute» to create plant

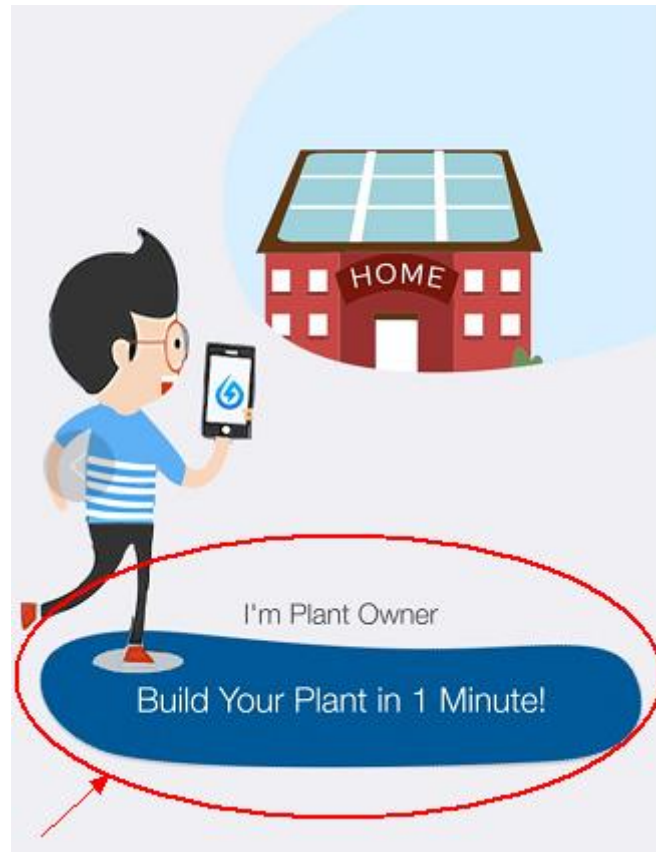

- c. Scan/Enter WiFi serial number (SN) (Note: If you see the message «**Logger connected**» after checking SN number, please ensure there are no other accounts associated with the entered WiFi SN)

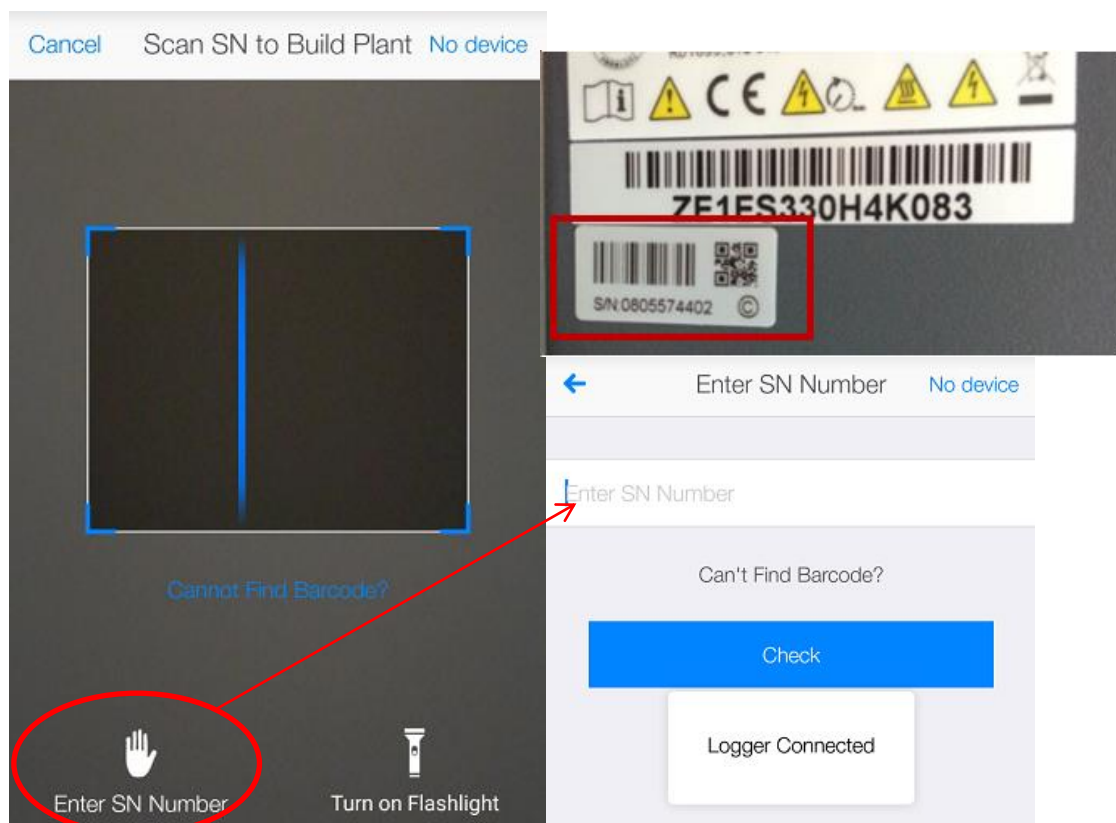



d. Enter Plant info:

[Back](#)
[Confirm Plant Info](#)
[Next](#)

Plant Location

Longitude 151°12'27"
Latitude -34°51'51"

Plant Address

New South Wales Sydney Sydney

Plant Type

Resi Roof

Commercial

Industrial

Utility

Grid Type

Distributed Self Use Left on Grid

Distributed All Power on Grid

Ground All Power on Grid

Offline



Storage System

i. Locate the plant on the maps

[Back](#)
[Confirm Plant Info](#)
[Next](#)

Plant Location

Longitude 151°12'27"
Latitude -34°51'51"

Plant Address

New South Wales Sydney Sydney

Plant Type

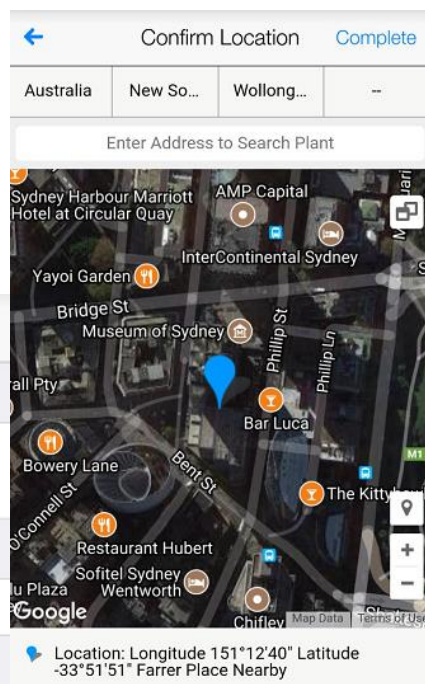

- ii. Configure plant type. Choose «Resi Roof» & «Storage System».

Plant Type

Resi Roof

Commercial

Industrial

Utility

Grid Type

Distributed Self Use Left on Grid

Distributed All Power on Grid

Ground All Power on Grid

Offline

Storage System

- e. Fill in plant capacity and other details

Capacity (kWp)
5

Direction

0°(N)

N

W

E

S

Tilt Angle

- f. Name the plant and put in installer/person who manages the app.

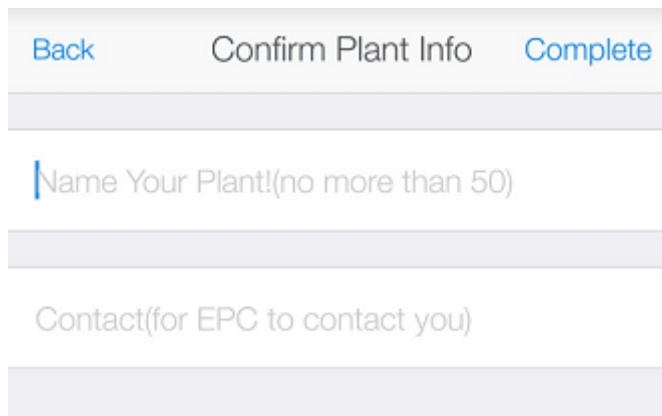

- g. Check and ensure the correct WiFi SN has been entered.

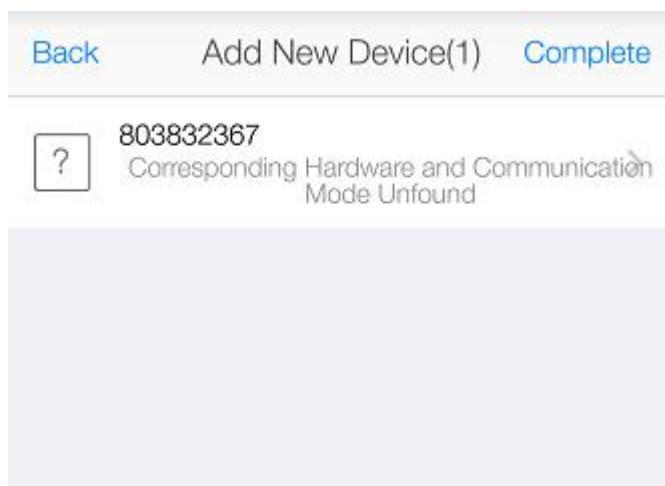

Choose «Complete» to finish configuration. After configuration has successfully completed, please wait for 10-20min (depend on network speed) for the WiFi logger to establish connection and upload data to the server. You should see the following screen and a green tick once inverter has established the connection. ***Please note that the data uploads frequency is every 5 minutes.***

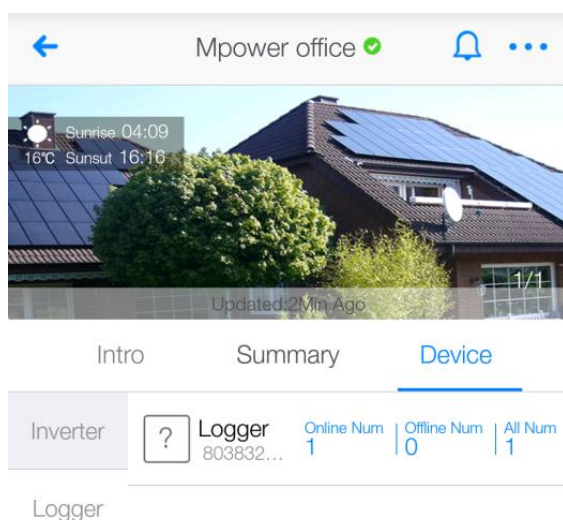

If configuration fails, please ensure inverter WiFi is connected to local router and there's established internet connection. If problem persists, please contact customer service.